



PROJECT: SCRIBBLE CHRISTMAS TREE NECKLACE PENDANT

By Jan Dwyer

Kit List:

32mm ImpressArt Aluminium Blank	860 A219
Beadalon 0.81mm x 7.6m 20 Gauge	
Silver Plated Artistic Wire	701 058
Silver Plated 2.3mm 18"/45cm Trace Chain	V2TS 23H
6mm Silver Plated Oval Jump Ring	N2H 112S
10ml Light Green Ecolor Enamel	861 012

10ml Transparent Ecolor Enamel	861 100
<i>Round Pure Brilliance Cut Swarovski Zirconia Stones:</i>	
3mm White	6SZA 30A
2mm Fancy Purple	6SZA 20K
2mm Fancy Blue	6SZA 20C
2mm Red	6SZA 20F
2mm Amber	6SZA 20H
2mm Fancy Morganite	6SZA 20N
Ecolor Enamelling Stove Set	861 703
Sieve Tops	861 700
Wire Flush Cutters	997 XU06
Short Flat Nose Pliers	997 XU13
Round Nose Pliers	999 698
Nylon Jaw Flat Nose Pliers	999 725S
Nylon Hammer	997 3125
Reverse Action Tweezers	999 1258
Pen	
Paper	

1



1: MAKE A TEMPLATE

Draw around the blank pendant and 'scribble' your Christmas tree as shown to make a template.

2



2: CREATE THE SHAPE

Working from the wire reel, follow your template with the wire to create your Christmas tree shape.

3

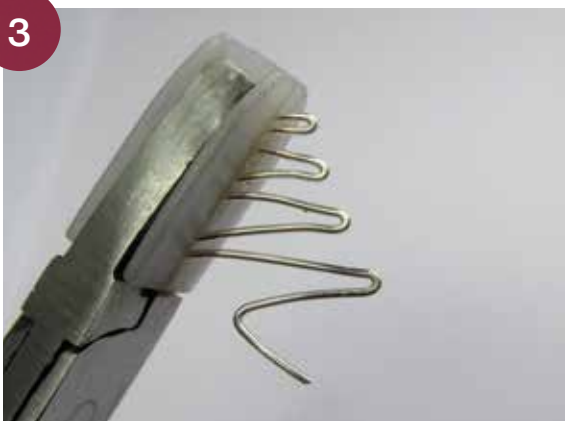

3: FLATTEN THE WIRE

Using nylon pliers or a nylon hammer make sure the wire Christmas tree is completely flat.

4



4: MAKE THE JUMP RINGS

Using round nose pliers, make five small jump rings with approximately a 1.5mm inner diameter, to sit the 2mm Swarovski in and one 2.5mm inner diameter jump ring to sit the 3mm Swarovski in. Sit each Swarovski into the jump rings as shown.

5



5: PLAN YOUR DESIGN

Place the small jump rings with Swarovski, in place onto the paper template where you want them in readiness for placing on the actual pendant as shown.

6



6: EFCOLOR AND ASSEMBLE YOUR PENDANT

Cover the pendant blank with a generous even layer of the light green EfcOLOR, then using tweezers or pliers place the wire Christmas tree onto the pendant trying not to disturb the EfcOLOR powder. (If you disturb the EfcOLOR just tip the powder off and put back into the pot, clean your pendant and start again).

7



7: PLACE ON THE STOVE

Carefully pick up the pendant and place it on the stove as shown. Leave for 3–5 minutes or until the enamel is smooth and shiny, then remove it from the stove to cool.

9



9: PLACE BACK ON THE STOVE

Place back onto the stove for 3–5 minutes or until the Efcolor is transparent and smooth. Remove and leave to cool.

8



8: EFCOLOR AGAIN

Cover the whole pendant with a light layer of transparent Efcolor and place the jump rings with the Swarovski, in place onto the pendant. Cover again with a light layer of transparent Efcolor.

10



10: FINISH OFF

Add a jump ring and chain and you are now ready to wear your pendant.