



Level of
design:
Advanced



CLOISONNÉ EARRINGS

By Aimee Skelton

What you'll need:

Prometheus Mini Kiln	855 1004
2x Fine Silver Oval Blanks	YTP 078
Fine Silver Rectangular Wire	KSFP 0100
Silver Creole Hoops	NVJ0 0560
Silver Flux Enamel	860 551
Blu-Stic Gum Adhesive	860 146
Diamond Tweezers	999 136
Straight Shears	999 658
Firing Fork	860 099
Stainless Steel Mesh Rack	860 093
Pallet Knife	860 100
Burner Rest	861 702
Cup Mask	998 066
Safety Glasses	999 244
Diagrit Sponge	860 121
Wet and Dry Paper	975 060/975 070 /975 080/975 090
Micromesh Sheets	999 DDG/999 DDD/999 DDE
Silicone Rubber Wheel	977 040
Mandrel for Silicone Rubber Wheel	999 AET
Pendant Motor	999 FD01
3x Enamel colours of your choice	
Distilled Water	
Fine Paint Brush	

1: DRAW & TRACE

Draw or print out your design onto paper and trace around the lines with the fine Silver wire using a pair of fine tweezers to achieve the sharp bends. Keep checking the shape against the drawing and the fine Silver blanks to make sure that they fit. While wearing safety glasses, use a pair of snips to cut the wire once you have achieved your desired shape.

1



2: PREPARE

Prepare the enamels by washing them in distilled water. I used Kingfisher (860 408), Pale Blue (860 425) & Medium White (860 523). Once washed, leave the enamels immersed in the water ready for painting onto the fine Silver blanks.

SAFETY TIP

While working with powdered enamels always use a cup mask to prevent breathing them in.

2



3: APPLY

Apply a thin base layer of Silver enamel flux onto the surface of the fine Silver blanks and fire for one minute on a steel mesh at 820°C. Carefully remove it from the kiln using a firing fork and place on a heat resistant rest allowing the pieces to cool down fully before handling.

3

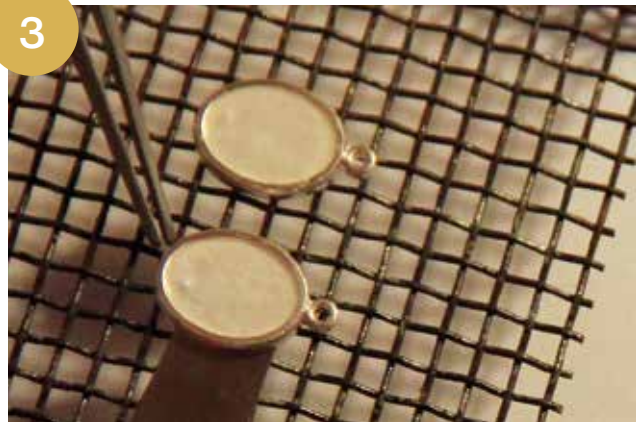

4: DIP

Using Blu-Stic gum adhesive, dip the wire shape in at an angle covering just the base. Position the wires onto the pre-enameled blanks and allow them to dry fully before firing in the kiln.

4



5: FIRE

Fire the blanks in the kiln at 820°C for one minute to allow the wire to stick to the surface as the enamel melts. Straight after removing the pieces from the kiln, gently press the wires with a pallet knife to make sure they are fully attached and have no gaps underneath. Ensure that you are properly supporting the piece on the wire mesh while doing this as it will be extremely hot.

5



6: PACK

Begin wet packing the enamels into the wire shapes. Don't build up the layers too thick. It is best to work with thin layers to prevent cracking after firing. Allow the piece to fully dry before firing in the kiln. Once dry, fire again for 1 minute at 820°C.

6

**7: BUILD UP THE LAYERS**

Continue building up the layers and firing in the kiln until they are level with the edge of the oval blank.

7

**8: SAND**

Using a Diagrif sponge, start to sand the cloisonné wires and enamel so that they are flush to the surface. Always do this under water and wear a cup mask. Once the enamel is completely flush to the edge of the oval blank, wash off any dust and re-fire to restore the shine of the enamels.

9: FINISH

To finish, sand the backs of the oval blanks using wet and dry paper. Work your way through the grits starting with 600 and finishing with 1200. Take your time to make sure you are removing any scratches on the surface.

9

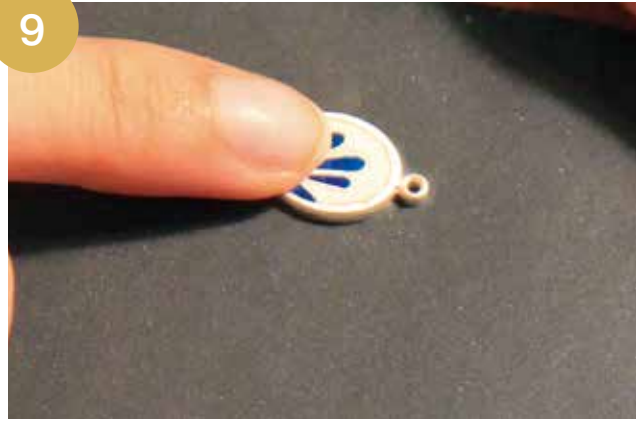
**10: SHINE**

Once you have finished sanding the pieces with wet and dry paper, move onto micromesh to bring the backs up to a high shine, starting with coarse and finishing with fine.

10

**11: POLISH**

Use a fine rubber wheel and pendant motor to gently polish the edges of the fine Silver blanks to bring them up to a high shine.

HEALTH & SAFETY

Always wear safety glasses when polishing.

11

**12: ASSEMBLE**

Hook the finished enamel pieces onto the creole hoops to complete the earrings.